



The Old Rectory

Acrise, Kent

One of East Kent's
most captivating Georgian rectories

The Old Rectory, Acrise, Kent CT18 8LJ

M20 5 miles, Folkestone station HS1 6 miles, Canterbury 15 miles





Features:

Entrance hall, Drawing room, Sitting room,
Dining room, Library, Kitchen/breakfast room,
Utility room, Cloakroom, Cellar, Workshop,
6 Bedrooms, 3 Bathrooms, Studio/playroom,
Double garage, Garden

About 2 acres







The Property

Tucked away in a beautifully rural and unspoilt corner of East Kent, and surrounded by traditional parkland, The Old Rectory is one of the most elegant Grade II Listed rectories in the surrounding area.

Set in a beautiful garden, giving good levels of seclusion, the peace and quiet of the location is palpable. The house has been the subject of considerable expenditure over the past 10 years and is now presented in a most sympathetic and appealing manner.

A wide entrance vestibule leads into a welcoming hall, off which all the reception rooms are reached. The drawing room is a magnificent room with triple aspect, tall sash windows, and doors out to the verandah. The hall is painted in a trompe d'oeil panelled effect. The cosy library with fitted bookshelves leads through to the sitting room, a wonderful room with a tall bay and sash windows overlooking the garden. This superb suite of reception rooms is completed by the dining room, a lovely room for formal entertaining. A handmade fitted kitchen with painted wooden and oak units has space for family dining and has double doors out to the patio. Beyond the kitchen are useful boot and boiler rooms which lead to a rear courtyard and a passageway leads to the double garage.

An elegant staircase rises to the landing with a glazed dome. The master bedroom is similarly elegant with triple aspect and a wonderful sense of space. The adjoining bathroom completes the master suite. There is a well fitted shower room, which is shared by the principal guest bedroom and two further bedrooms, off the front landing. A rear passageway leads to the final two bedrooms and third bathroom. A small secondary staircase leads down to the kitchen. A "secret" doorway from bedroom 6 opens into the studio/playroom, a light space with stairs down to the rear passage.

Location

The Old Rectory is situated in a beautiful rural location surrounded by woods and farmland in a designated Area of Outstanding Natural Beauty. Acrise lies about 1.5 miles south east of the village of Elham which, together with Lyminge (about 3 miles) provides day-to-day amenities.

The cathedral City of Canterbury offers a good range of educational facilities, both in the independent and state sectors, together with extensive shopping and leisure facilities. Transport links in the area are excellent, with the M20 providing access to the remaining southern motorway network. Stations at Folkestone Central and Ashford International provide the High Speed service into London St Pancras with journey times of 55 and 37 minutes respectively.





Approx gross internal area*:
6,013ft² = 558.7m²

Illustration for identification purposes only. Not to scale.

*As defined by RICS – Code of Measuring Practice.

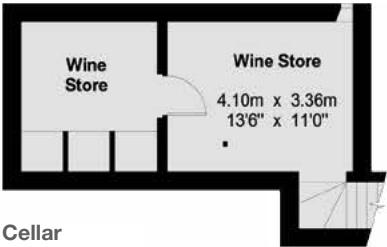

Cellar



Ground Floor



First Floor

General

Local Authorities: Shepway District Council (01303 853000); Kent County Council (03000 414141)

Services: The Old Rectory has mains electricity?? gas?? oil?? water?? drainage??-fired heating.

Directions

From Canterbury proceed onto the A2 towards Dover. After about 5 miles take the A260 turning towards Folkestone. After approximately 5 miles, in Densole, turn right (signposted to Alkham), follow the lane and drop down in to the valley, bending round to the left. Where the road bends sharply to the right, turn left into the drive of The Old Rectory.



Reproduced from the Ordnance Survey Mapping with the permission of the Controller of Her Majesty's Stationery Office. Crown Copyright (ES763454). NOT TO SCALE

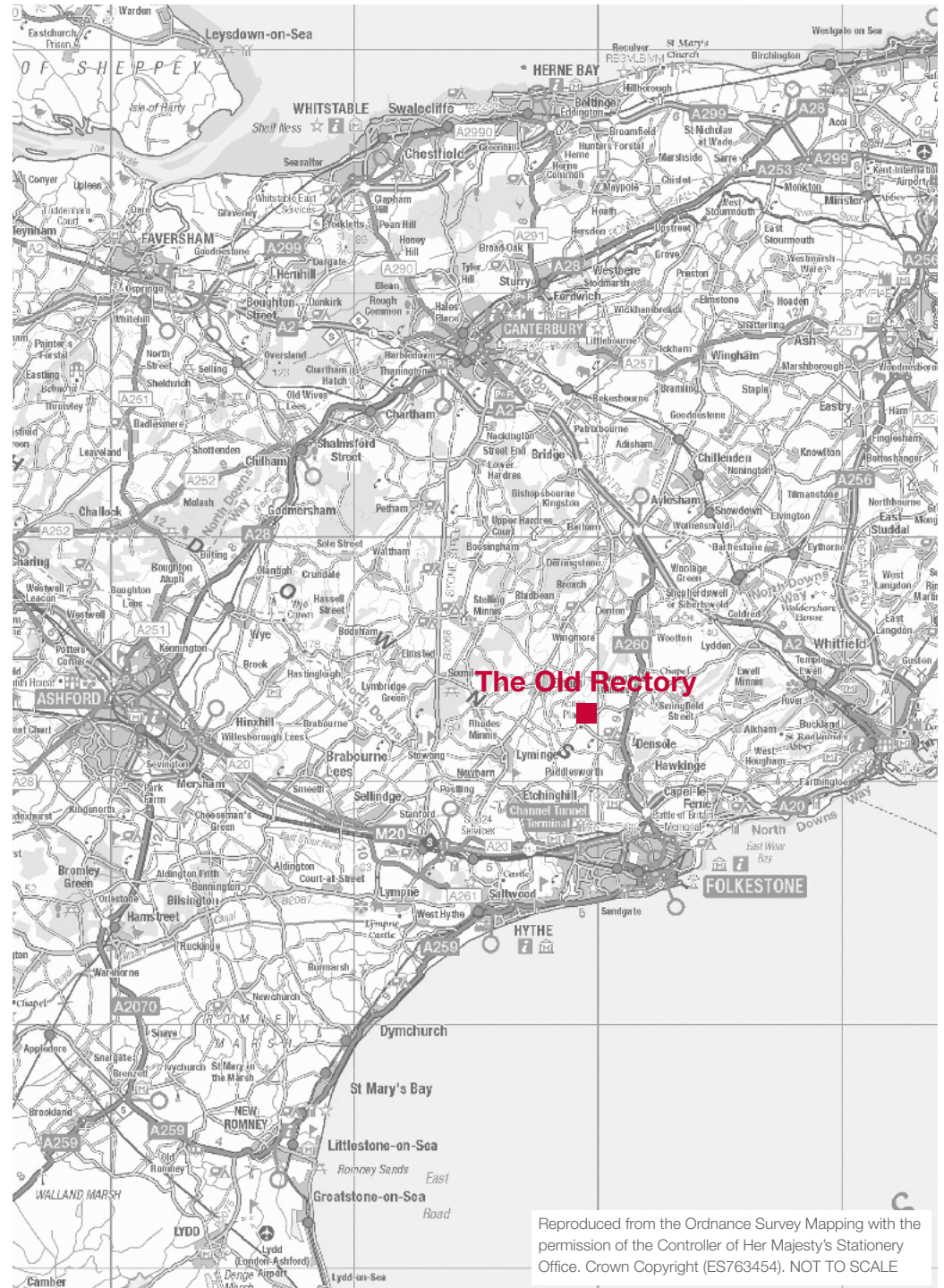

Reproduced from the Ordnance Survey Mapping with the permission of the Controller of Her Majesty's Stationery Office. Crown Copyright (ES763454). NOT TO SCALE

Strutt & Parker Canterbury
2 St Margaret's Street, Canterbury, Kent CT1 2SL

+44 (0)1227 451123
canterbury@struttandparker.com
struttandparker.com

50 offices across England
and Scotland, including 10 offices
in Central London

exclusive affiliate of
CHRISTIE'S
INTERNATIONAL REAL ESTATE

 OnTheMarket.com

IMPORTANT NOTICE Strutt & Parker LLP gives notice that: 1. These particulars do not constitute an offer or contract or part thereof. 2. All descriptions, photographs and plans are for guidance only and should not be relied upon as statements or representations of fact. All measurements are approximate and not necessarily to scale. Any prospective purchaser must satisfy themselves of the correctness of the information within the particulars by inspection or otherwise. 3. Strutt & Parker LLP does not have any authority to give any representations or warranties whatsoever in relation to this property (including but not limited to planning/building regulations), nor can it enter into any contract on behalf of the Vendor. 4. Strutt & Parker LLP does not accept responsibility for any expenses incurred by prospective purchasers in inspecting properties which have been sold, let or withdrawn. 5. If there is anything of particular importance to you, please contact this office and Strutt & Parker will try to have the information checked for you. Photographs taken May 2015. Particulars prepared June 2015.

STRUTT&PARKER